



Capacitive Sensors
Series 70 - NPN
Series 80 - PNP

Housing M 18 x 1

- Housing material: Brass
- Sensing distance 1...10 mm adjustable

Certificate:



| | |
|---|------------------------------------|
| Technical data | Non-flush mountable |
| Operating distance S_n | 8 mm |
| Operating distance min. / max. adjustable | 1...10 mm |
| Electrical version | 4-wire DC |
| Output | Antivalent |
| Type NPN | KAS-70-A23-A-PTFE/MS-NL |
| Art.-No. | KA 0437 |
| Connection diagram No.. | 3 |
| Type PNP | KAS-80-A23-A-PTFE/MS-NL |
| Art.-No. | KA 0725 |
| Connection diagram No. | 6 |
| Operating voltage (U_B) | 12...30 V DC |
| Output current max. (I_o) | 2 x 200 mA |
| Voltage drop max. (U_d) | ≤ 2.0 V |
| Permitted residual ripple max. | 5 % |
| No-load current (I_o) | < 15 mA |
| Frequency of operating cycles max. | 50 Hz |
| Permitted ambient temperature | -25...+70 °C |
| LED-display | Yellow |
| Protective circuit | Built-in |
| Degree of protection IEC 60529 | IP 67 |
| Norm | EN 60947-5-2 |
| Connection | 2 m, PVC, 4 x 0.34 mm ² |
| Housing material | Brass |
| Active surface | PTFE |
| Lid | PA / PPO |

All specifications are subject to change without notice. (29.01.2010)

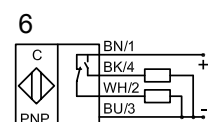
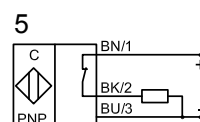
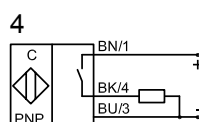
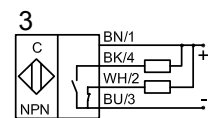
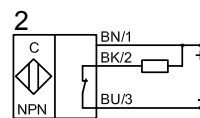
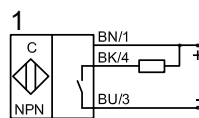
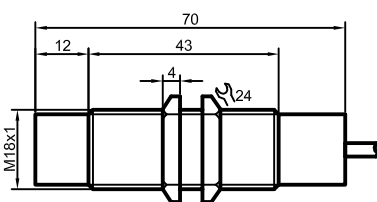

Made in Germany